

Kapasite / Capacity	360	550	800	1180	kg
Gerekli el kuvveti / Required hand force	20	14	22	10	kg
Dişli oranı / Gear ratio	4.1 : 1	4.1 : 1	5 : 1	10 : 1	
İrgat göbek çapı / Hub diameter	40	50	70	80	mm
Kol uzunluğu / Handle length	160	210	320	320	mm
Halat çapı / Cable diameter	4	4,8	6,4	8	mm
Kablo muhafaza kapasitesi / Cable storage cap.	36	23	24	18	m
Birim ağırlığı / Unit weight	3	3.3	8	10.3	kg

- Kompakt, hafif ve sağlam ürün yapısına sahiptir.
- Dişliler ve fren mekanizması, toz, kir ve yağmur atıklarından korumayı sağlamak üzere kapalı sistem tasarlanmıştır.
- Operatör ürünü kullanırken çok az enerji sarf eder.
- Üniversal montaj plakasına sahiptir.
- Renkli fırınlanmış emaye kaplama sayesinde korozyon dayanımını artırmıştır.

- Positive load, actuated brake can hold the load in any position
- Compact, light-weight and rugged construction
- Gears and brake are fully covered to prevent dust, dirt and rain contamination
- Very low operator effort is required for easy operation
- Universal mounting base
- Baked yellow enamel paint finish for corrosion protection

Art.No. 52000190

NL-BHW 800

Art.No. 52000127

NL-BHW 1200

Art.No. 52000128

NL-BHW 1800

Art.No. 52000191

NL-BHW 2600

Art.No. 52000192

NL-BHW 800 PLUS

Art.No. 52000193

NL-BHW 1200 PLUS

Art.No. 52000194

NL-BHW 1800 PLUS

Art.No. 52000195

NL-BHW 2600 PLUS



PLUS

Galvaniz model  
Galvanized model

NL- BHW 2600

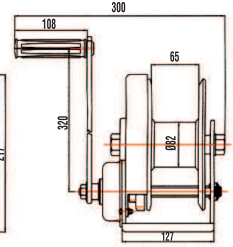
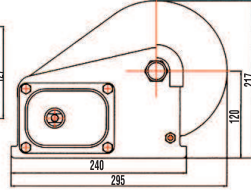
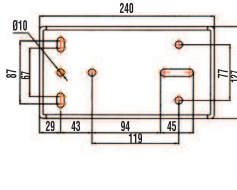

NL- BHW 1800

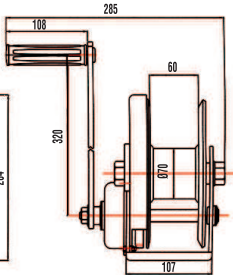
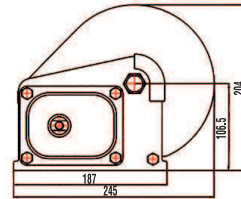
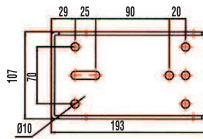

NL- BHW 1200

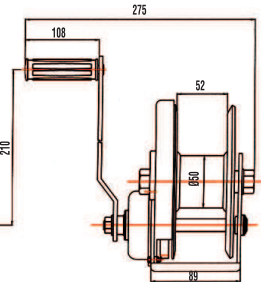
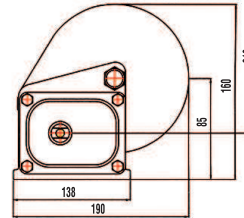
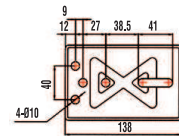

NL- BHW 800

